



CONCIERIA

SHIBA KOEN
コンシェルシア芝公園



FACT SHEET

Tokyo Monthly 21 offers fully furnished apartments for the short or long stay traveler. If hotel life is a little too busy or intrusive for you, then you will love these new private apartments equipped with all the furnishings of home. **Concieria Shiba Koen** is in downtown Minato-ku district and walking distance to Kamiyacho and Hamamatsucho areas. Recessed in a quiet neighborhood and surrounded by Seisho-ji Temple, Shiba Palace Garden, and Shiba Koen Park, this is a perfect location for the professional that wants a balance of tranquility and public access.

Rates

Room Type	Size (m ²)	Weekly Rate	Additional Day
Standard Studio	20 -21.7	¥73,200	¥12,200

Weekly Rate for stays of seven days (minimum allowed). Additional Day rates for additional days after 7 days. Monthly rates available for stays of 30 days or more. Rates are per room, per night and includes 5% consumption tax. Rates do not include linen and towel set. Rates are subject to change without notice. All rooms have a maximum occupancy of 1 person.

Furnished apartments only - Maid service not provided but available at additional cost. No front desk service on property. Please contact reservation office for key delivery and check in information.

Facility

15 floors and 100 units, 1 elevator, secured entrance and elevators, mail box, fire exit

Amenities

Bed, table and chair, desk and lamp, closet, hair dryer, iron and ironing board, flat screen TV, DVD Player, all flooring, vacuum cleaner closet and storage shelves, air-conditioning, broadband internet LAN w/cable, alarm clock, rice cooker, hot water pot, kitchenware and utensils, refrigerator/freezer, microwave, mirror, sink, gas burners and grill, pots & pans, cleaning material, washer/dryer, balcony, separated bathroom and toilet, shower/bathtub, toilet with bidet, fire detectors, double lock and dead bolt, security entrance display. **Telephone line not available in room.**

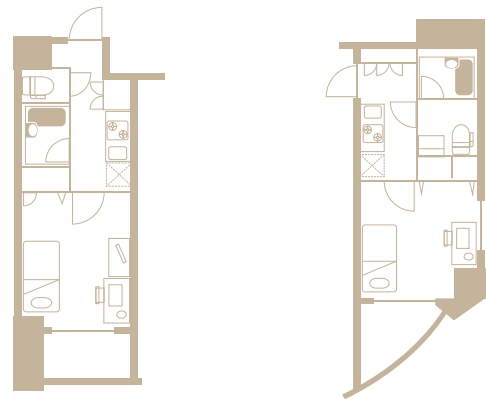

Nearby Attractions

Drugstore
Family Restaurants
Shopping Centers
Restaurants and Cafes
Seisho-ji Temple
Tokyo Tower
Hamarikyu Gardens

Nearby Hotels

Tokyo Prince Hotel
Prince Park Tower
Shiba Park Hotel
Hotel Sunroute Shimbashi

Nearby Business Complexes

Atago Green Hills
Keio University
Tokyo American Club
World Trade Center

Nearby Districts

Otemachi - 5 min.
Tokyo - 5 min.
Suidobashi - 10 min.
Hamamatsucho - 10 min.
Shibadaimon - 8 min.

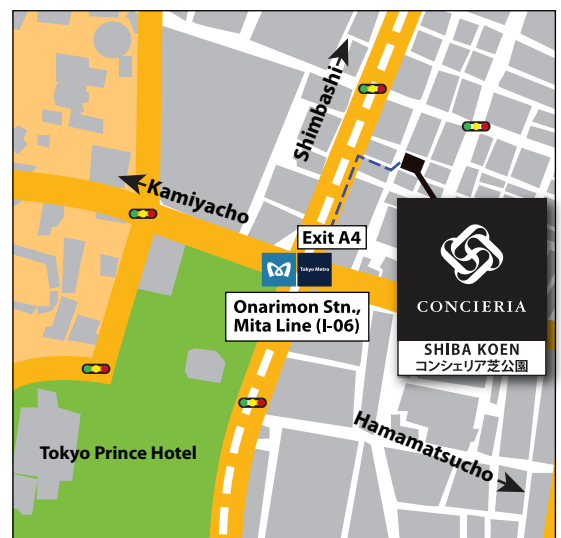

From Toei Mita Line, Onarimon Station (I-06) take exit A4. Walk straight along Hibiya-dori and take your 2nd right after the Bank of Tokyo Mitsubishi-UFJ. Walk for one more block, the property is across the street on the left corner.

Airport Access

Narita International Airport - Take the Airport Limousine bus to Tokyo Prince Hotel. 12-minute walk or 5-minute taxi ride.

Haneda International Airport - Take the Airport Limousine bus to Tokyo Prince Hotel. 12-minute walk or 5-minute taxi ride. Or take monorail to Hamamatsucho and 10 minute taxi ride.

TOKYO
MONTHLY21

東京マンスリー21

6-15-1 Shimbashi, Minato-ku, Tokyo 105-0004

T: +81-(0)3-5425-2547 | F: +81-(0)3-5425-2472 | E: info@tm21.co.jp

www.tm21.co.jp